

DIRTA

Aut. Comunale Intercomunale della Media e 1. Regione
- C.so Vittorio Veneto, 100 - 10121 TORINO - Tel. 011/261111

TAV. n° 2
- Rilievo stato di fatto
- Verifica standard urbanistici e cessioni aree
- Impianto elettrico, telefonico e pubblico
- Illuminazione

Scala
1:2000

Aut. Ingegneria
Ing. ...

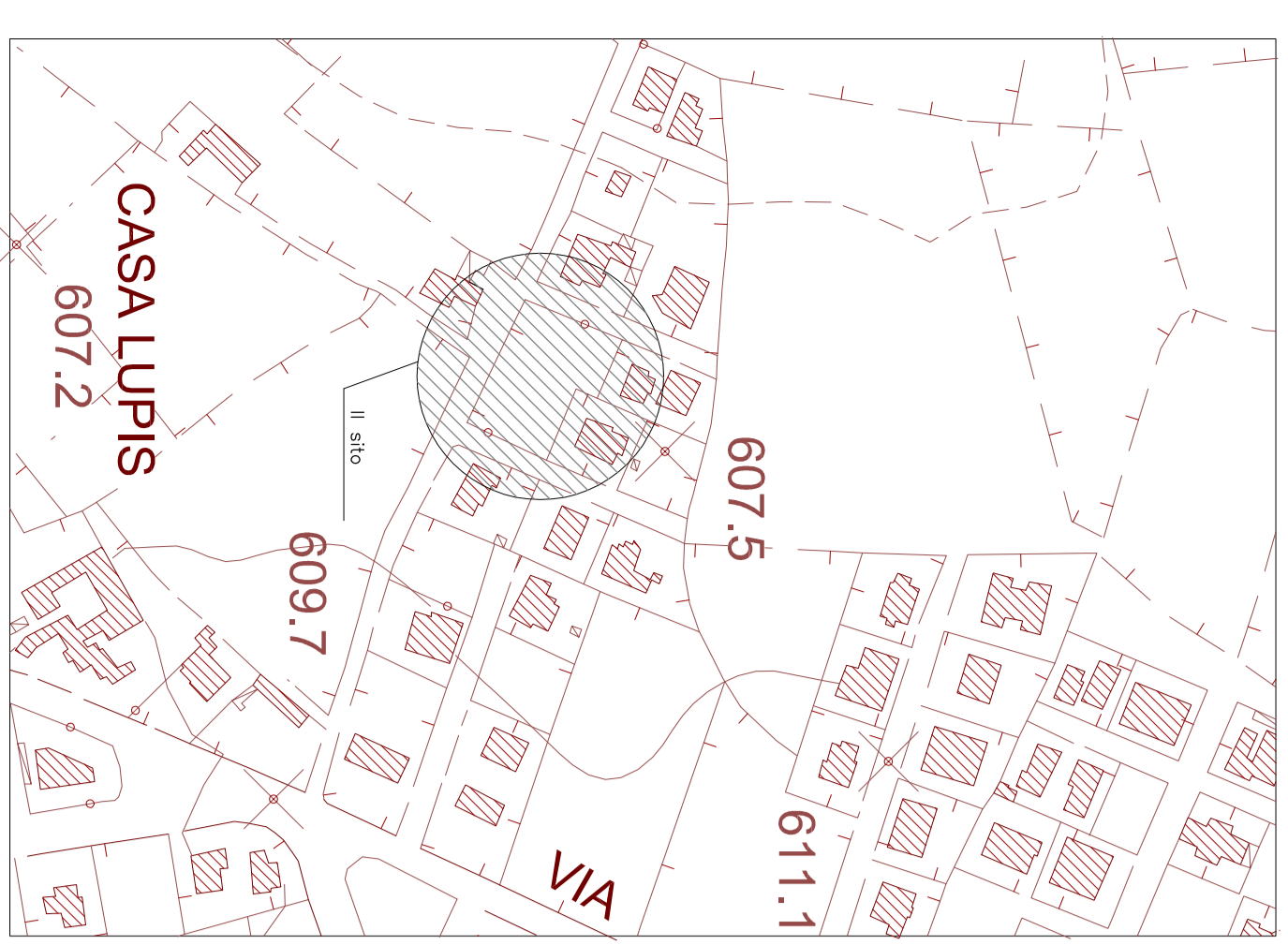
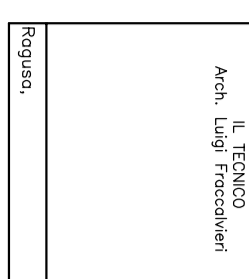

Stato aereofotogrammetrico
scala 1:2000

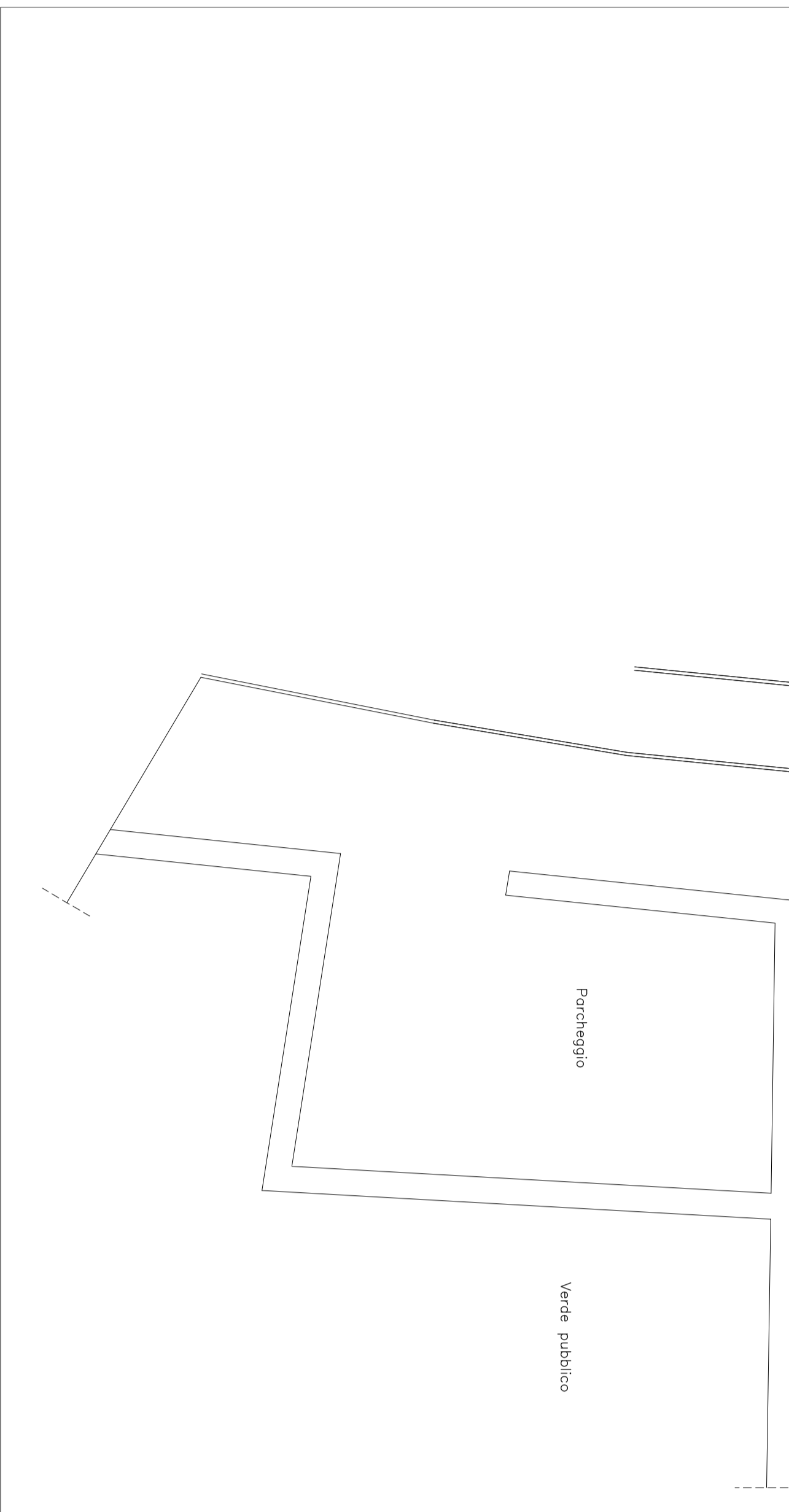
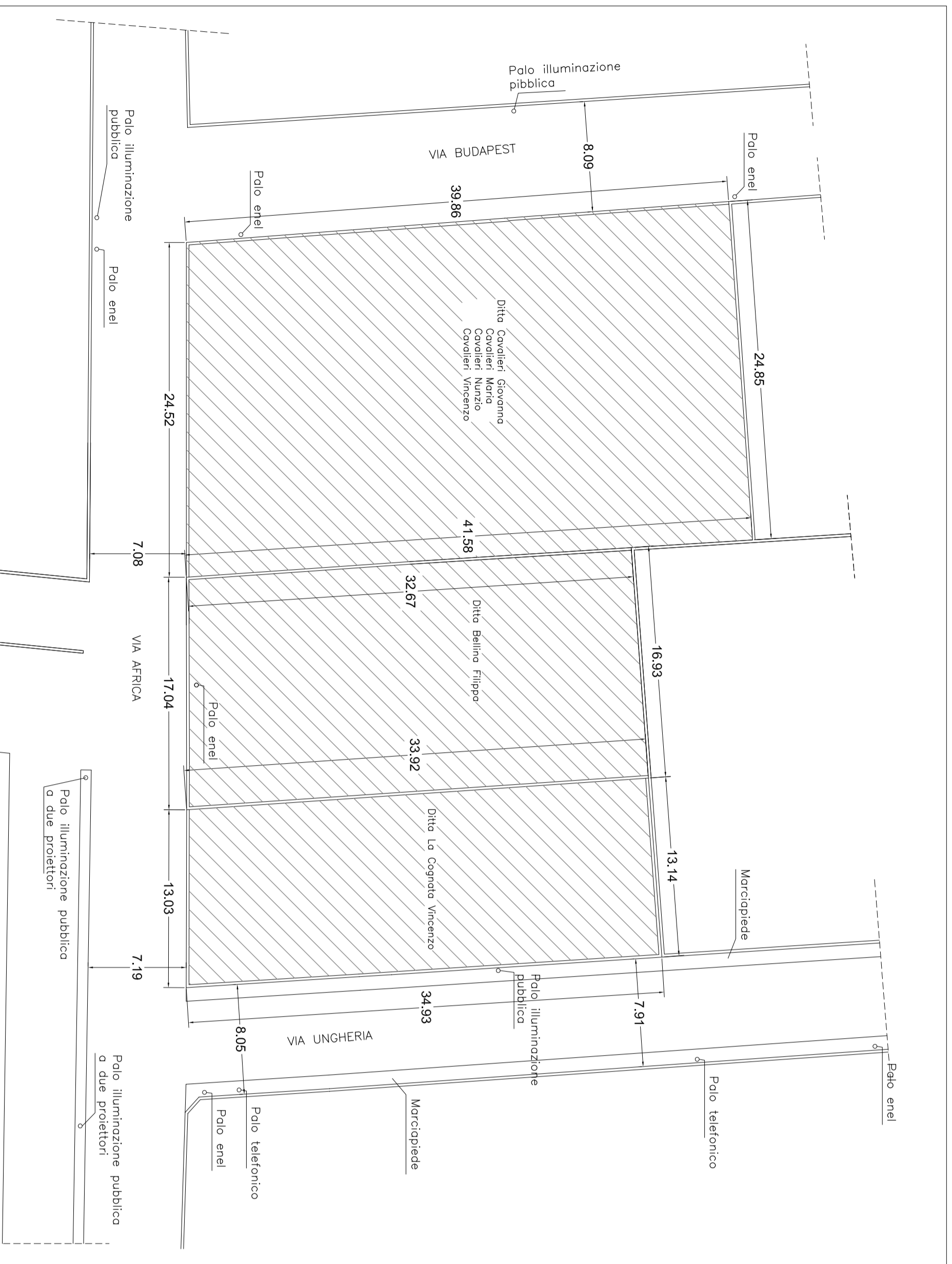

RIEUVO STATO DI FATTO

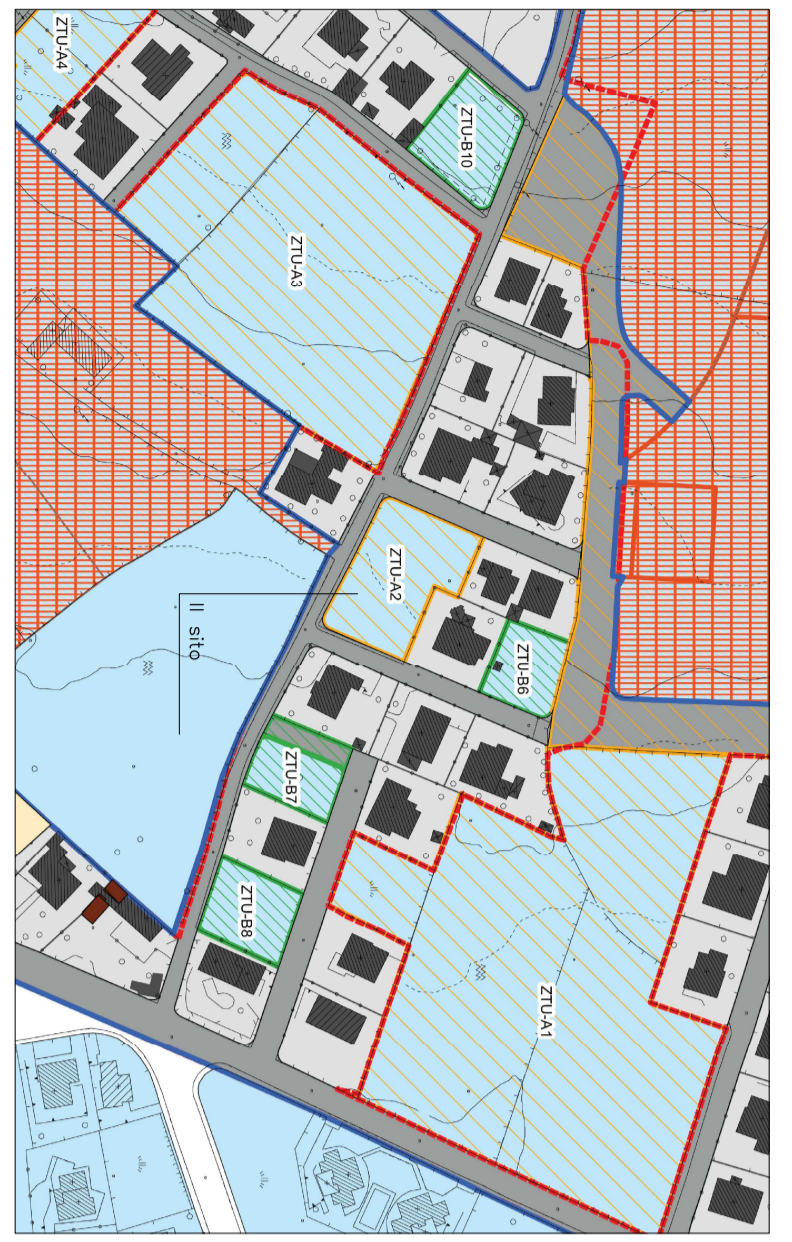

Strada P.R.C. 1:2000

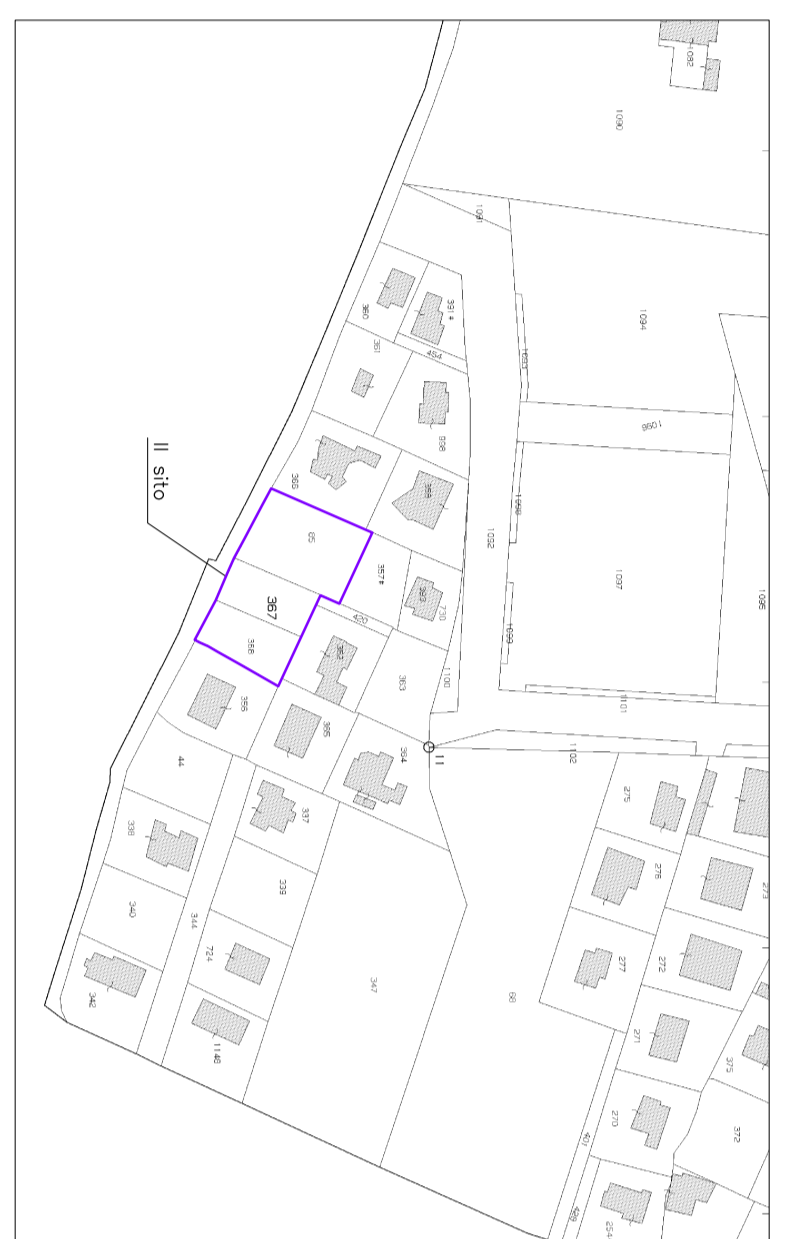

Strada catastale - F.81 Part. 367 - 368 - 65
scala 1:2000

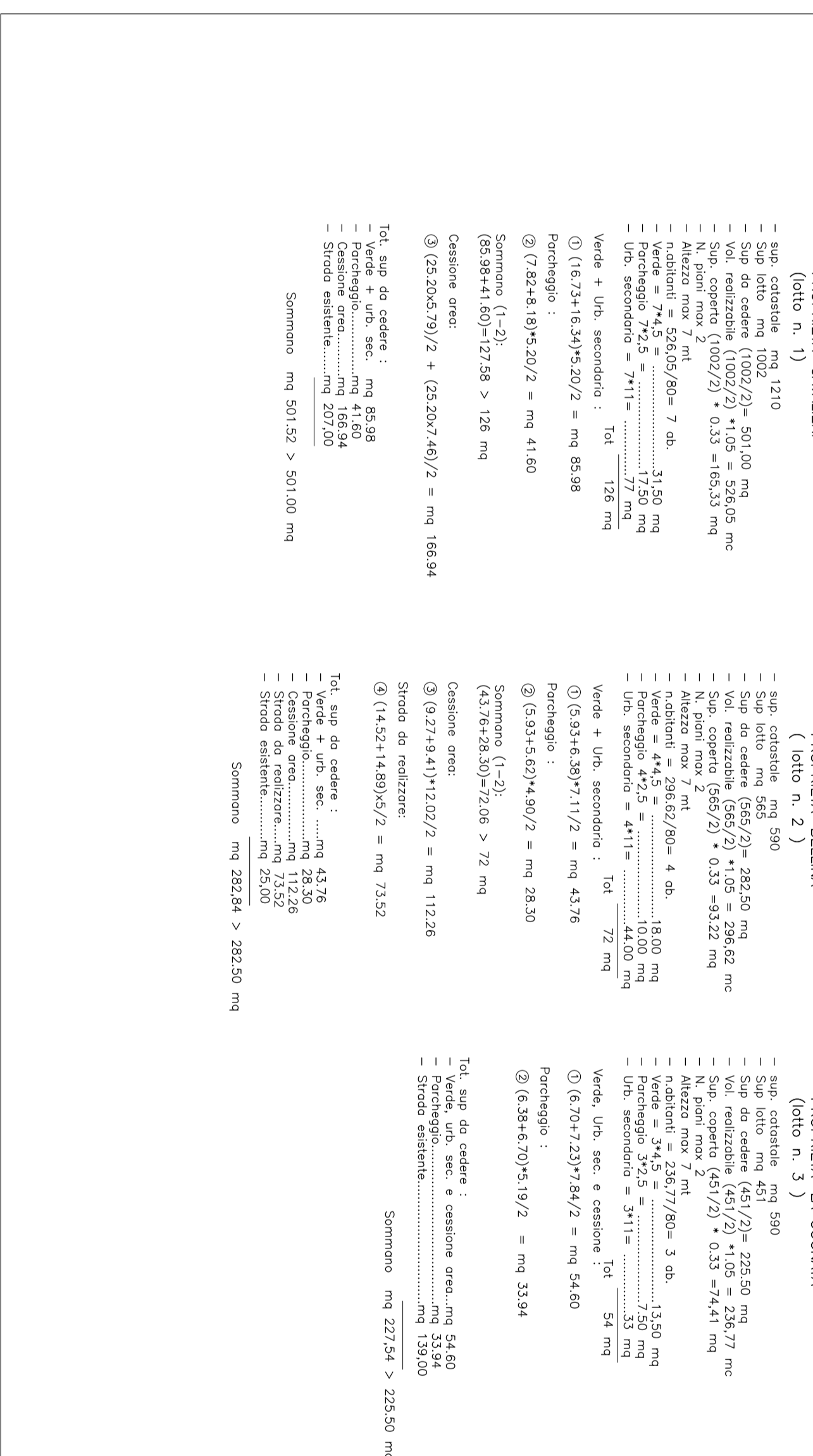
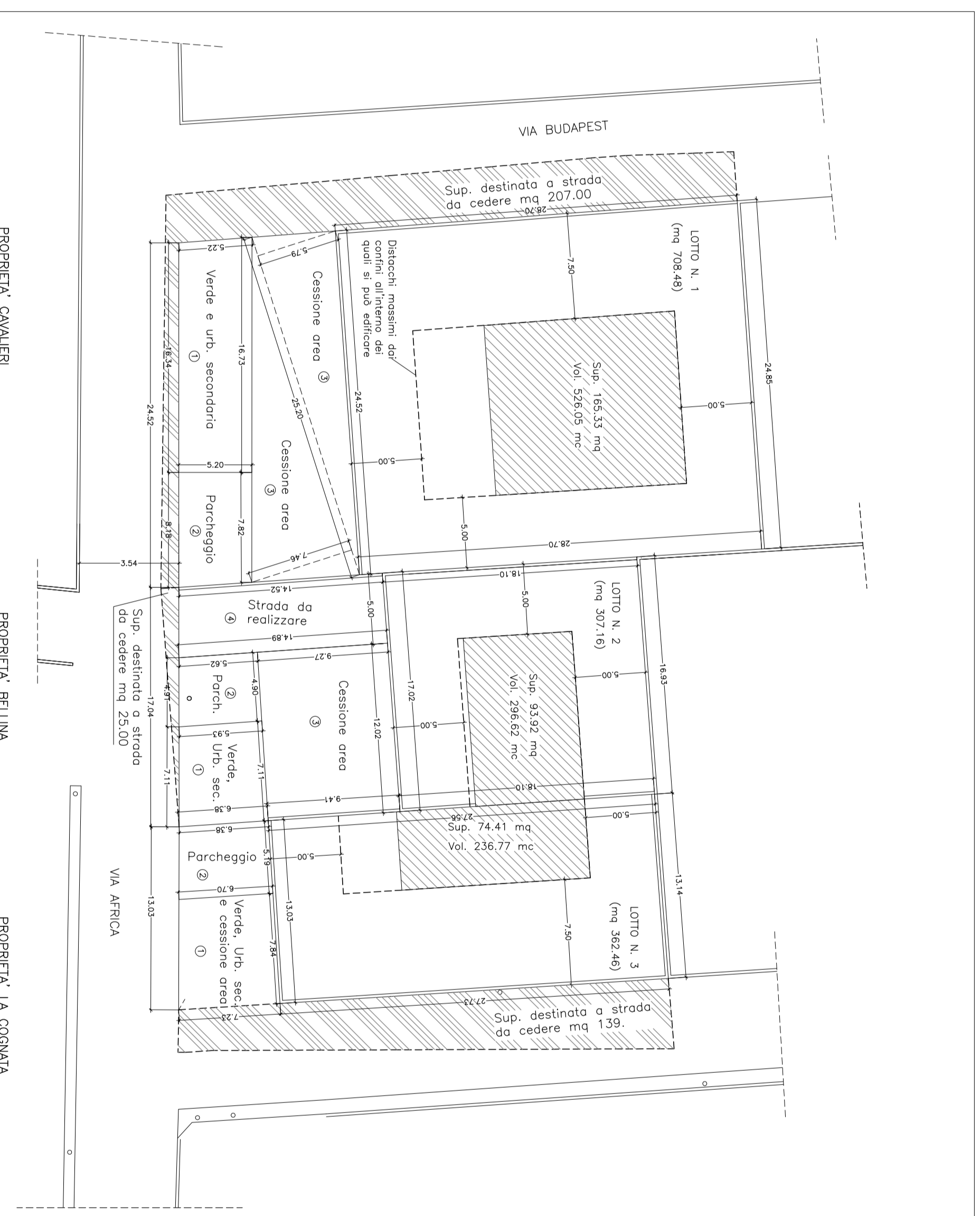

VERIFICA STANDARD URBANISTICI E CESSIONI

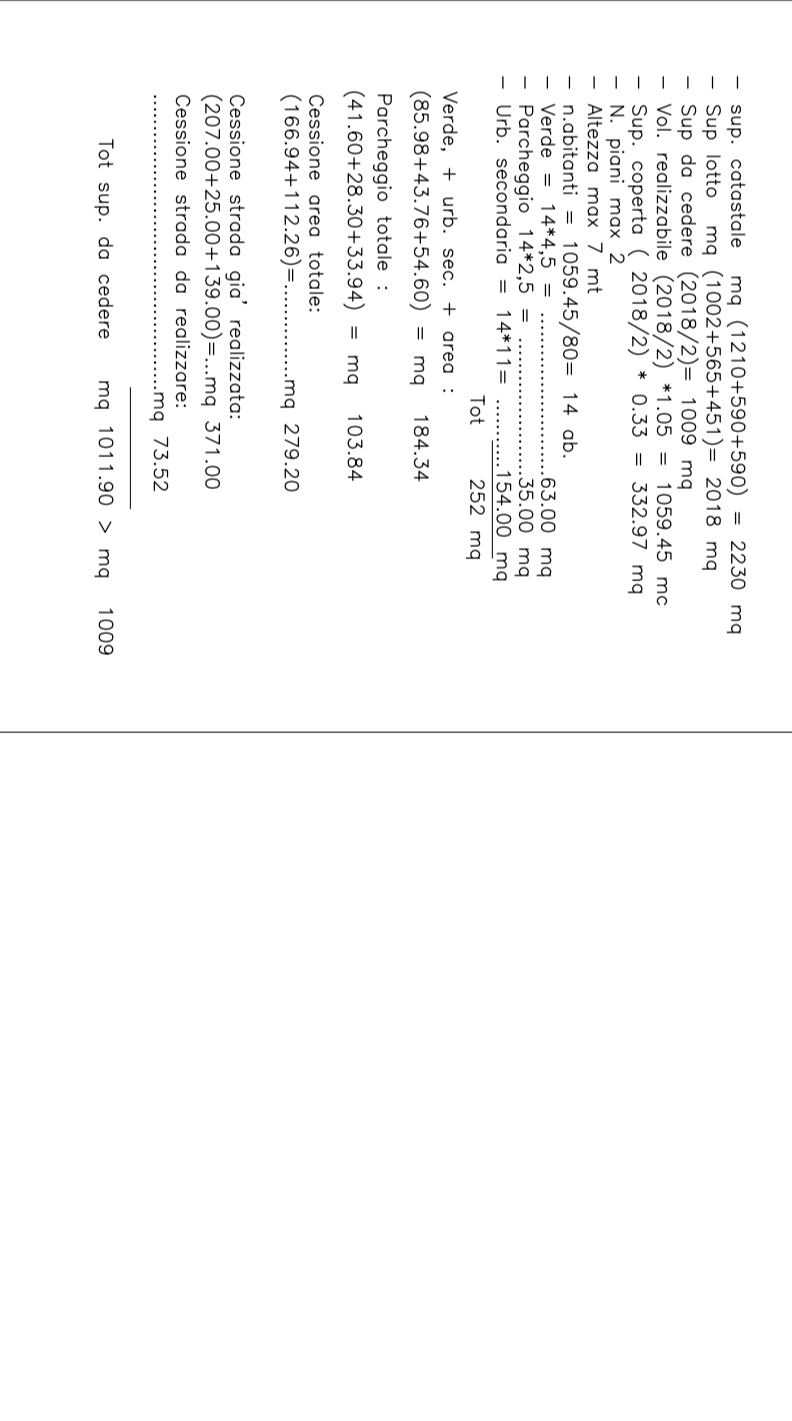

CONTEGGI URBANISTICI COMPLESSIVI

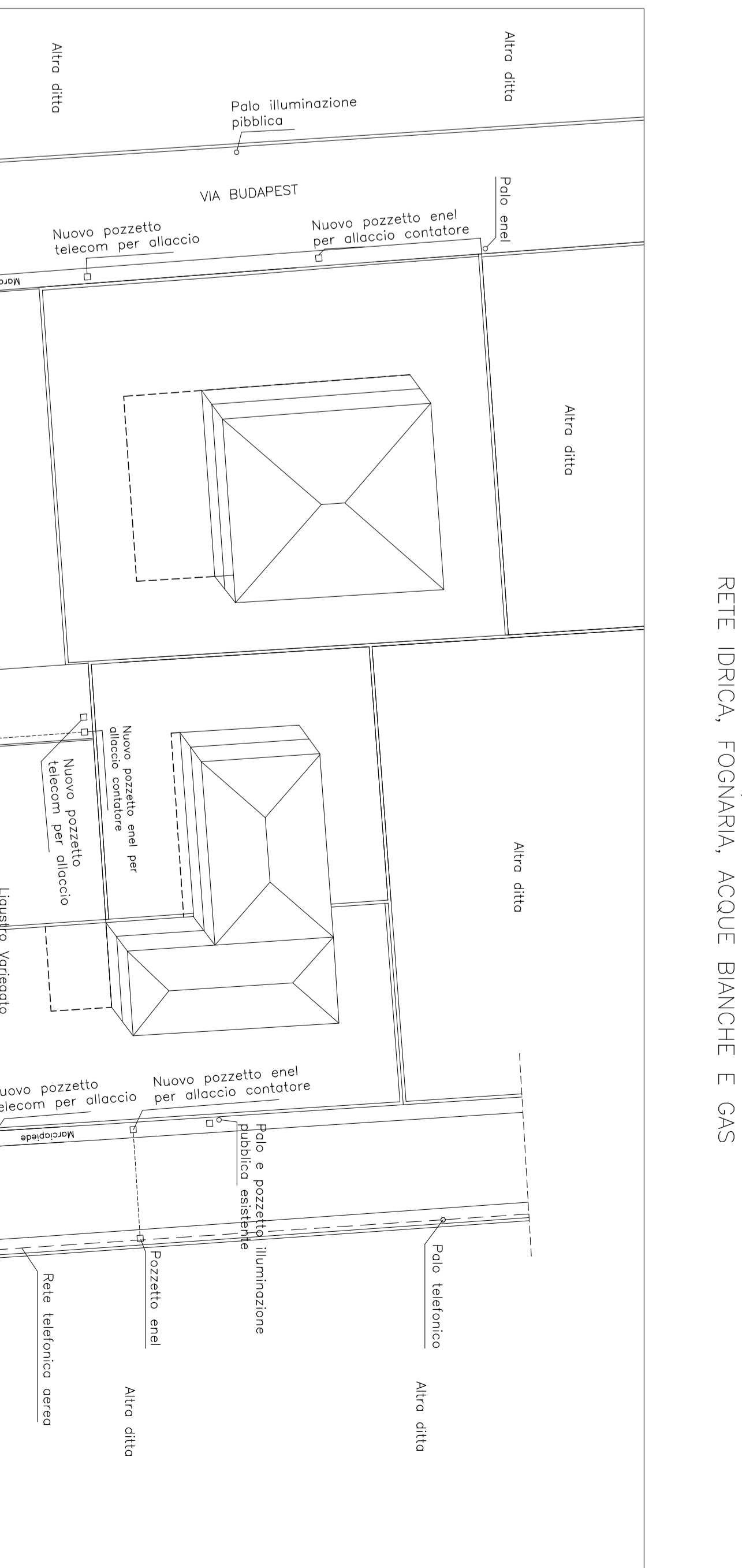

PIANOVOLUMETRICO,
RETE IDRICA, FOGNARIA, ACQUE BIANCHE E GAS

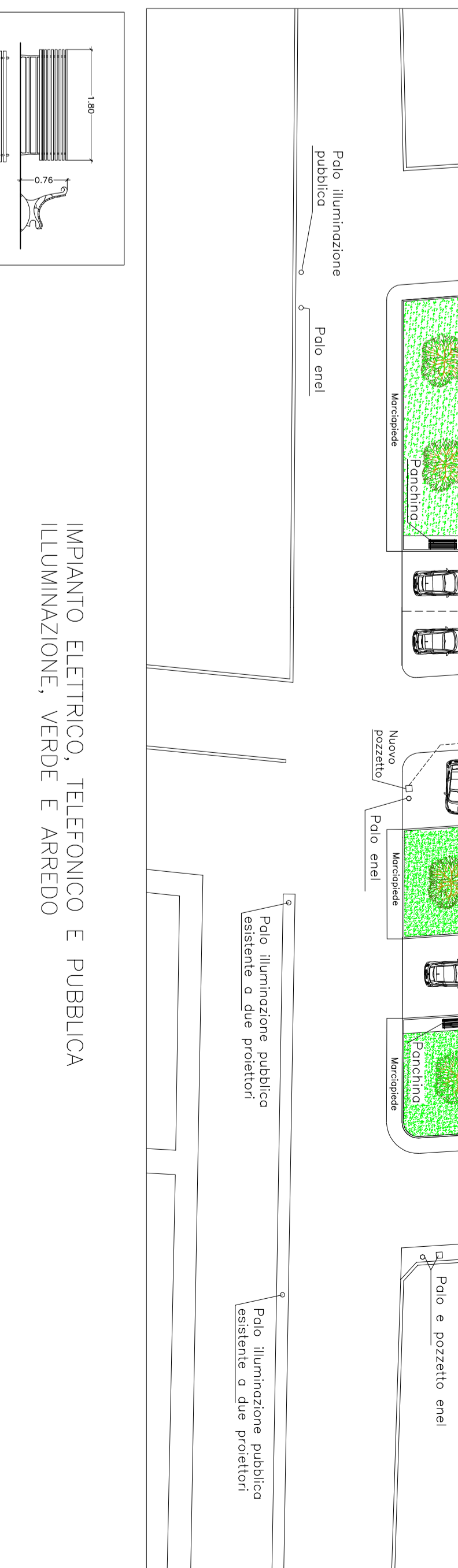

Parchino scala 1:50

IMPIANTO ELETTRICO, TELEFONICO E PUBBLICA
ILLUMINAZIONE, VERDE E ARREDO